

Site Inventory Form
State Historical Society of Iowa
 (December 1, 1999)

State Inventory No. 70-00162 New Supplemental
 Part of a district with known boundaries (enter inventory no.) _____
 Relationship: Contributing Noncontributing
 Contributes to a potential district with yet unknown boundaries
 National Register Status: (any that apply) Listed De-listed NHL DOE
 Review & Compliance No. _____
 Non-Extant (enter year) _____

1. Name of Property

historic name Commercial Building
 other names/site number Field Site #: FS-014

2. Location

street & number 205 W. 2nd St
 city or town Muscatine vicinity, county _____
 Legal Description: (If Rural) Township Name _____ Township No. _____ Range No. _____ Section _____ Quarter of Quarter _____
 (If Urban) Subdivision Original Town Block(s) 35 Lot(s) 5

3. State/Federal Agency Certification [Skip this Section]

4. National Park Service Certification [Skip this Section]

5. Classification

Category of Property (Check only one box)	Number of Resources within Property			
	If Non-Eligible Property	If Eligible Property, enter number of:		
	Enter number of:	Contributing	Noncontributing	
<input checked="" type="checkbox"/> building(s)	_____ buildings	<u>1</u>	_____	buildings
<input type="checkbox"/> district	_____ sites	_____	_____	sites
<input type="checkbox"/> site	_____ structures	_____	_____	structures
<input type="checkbox"/> structure	_____ objects	_____	_____	objects
<input type="checkbox"/> object	_____ Total	<u>1</u>	_____	Total

Name of related project report or multiple property study (Enter "N/A" if the property is not part of a multiple property examination).
 Title _____ Historical Architectural Data Base Number _____

Historical and Architectural Survey and Evaluation of the Downtown Commercial District 70-013

6. Function or Use

Historic Functions (Enter categories from instructions)	Current Functions (Enter categories from instructions)
<u>02E11: Commerce/Butcher/Meats</u>	<u>70: Vacant</u>
<u>02G: Commerce/Restaurant</u>	_____
<u>10E06: Industry/Publishing-Print Shop</u>	_____

7. Description

Architectural Classification (Enter categories from instructions)	Materials (Enter categories from instructions)
<u>09F: Commercial</u>	foundation _____
_____	walls <u>03: Brick</u>
_____	roof <u>08B: Asphalt/Rolled</u>
_____	other _____

Narrative Description (SEE CONTINUATION SHEETS, WHICH MUST BE COMPLETED)

8. Statement of Significance

Applicable National Register Criteria (Mark "x" representing your opinion of eligibility after applying relevant National Register criteria)

<input checked="" type="checkbox"/> Yes <input type="checkbox"/> No <input type="checkbox"/> More Research Recommended	A	Property is associated with significant events.
<input type="checkbox"/> Yes <input checked="" type="checkbox"/> No <input type="checkbox"/> More Research Recommended	B	Property is associated with the lives of significant persons.
<input type="checkbox"/> Yes <input checked="" type="checkbox"/> No <input type="checkbox"/> More Research Recommended	C	Property has distinctive architectural characteristics.
<input type="checkbox"/> Yes <input type="checkbox"/> No <input type="checkbox"/> More Research Recommended	D	Property yields significant information in archaeology or history.

County Muscatine
City Muscatine

Address 205 West Second Street

Site Number 70-00162
District Number _____

Criteria Considerations

- A Owned by a religious institution or used for religious purposes.
- B Removed from its original location.
- C A birthplace or grave.
- D A cemetery
- E A reconstructed building, object, or structure.
- F A commemorative property.
- G Less than 50 years of age or achieved significance within the past 50 years.

Areas of Significance (Enter categories from instructions)

05: Commerce

Significant Dates

Construction date

1860s

Other dates

check if circa or estimated date

Significant Person

(Complete if National Register Criterion B is marked above)

Architect/Builder

Architect

Builder

Narrative Statement of Significance SEE CONTINUATION SHEETS, WHICH MUST BE COMPLETED

9. Major Bibliographical References

Bibliography See continuation sheet for citations of the books, articles, and other sources used in preparing this form

10. Geographic Data

UTM References (OPTIONAL)

Zone	Easting	Northing	Zone	Easting	Northing
1	_____	_____	2	_____	_____
3	_____	_____	4	_____	_____

See continuation sheet for additional UTM references or comments

11. Form Prepared By

name/title Jay Brady, Chair (R.L. McCarley, Consultant)

organization Muscatine Historic Preservation Commission date June 23, 2005

street & number 215 Sycamore telephone 563-264-1554

city or town Muscatine state IA zip code 52761

ADDITIONAL DOCUMENTATION (Submit the following items with the completed form)

FOR ALL PROPERTIES

- Map:** showing the property's location in a town/city or township.
- Site plan:** showing position of buildings and structures on the site in relation to public road(s).
- Photographs:** representative black and white photos. If the photos are taken as part of a survey for which the Society is to be curator of the negatives or color slides, a photo/catalog sheet needs to be included with the negatives/slides and the following needs to be provided below on this particular inventory site:

Roll/slide sheet # _____ Frame/slot # _____ Date Taken _____
Roll/slide sheet # _____ Frame/slot # _____ Date Taken _____
Roll/slide sheet # _____ Frame/slot # _____ Date Taken _____

- See continuation sheet or attached **photo & slide catalog sheet** for list of photo roll or slide entries.
- Photos/illustrations without negatives are also in this site inventory file.

FOR CERTAIN KINDS OF PROPERTIES, INCLUDE THE FOLLOWING AS WELL

- Farmstead & District:** (List of structures and buildings, known or estimated year built, and contributing or non-contributing status)
- Barn:**
 - A sketch of the frame/truss configuration in the form of drawing a typical middle bent of the barn.
 - A photograph of the loft showing the frame configuration along one side.
 - A sketch floor plan of the interior space arrangements along with the barn's exterior dimensions in feet.

State Historic Preservation Office (SHPO) Use Only Below This Line

Concur with above survey opinion on National Register eligibility: Yes No More Research Recommended
 This is a locally designated property or part of a locally designated district.

Comments: _____

Evaluated by (name/title): _____ Date: _____

Iowa Site Inventory Form Continuation Sheet

Page 3

<u>Commercial Building</u> Name of Property	<u>Muscatine</u> County
<u>205 West Second Street</u> Address	<u>Muscatine, Iowa</u> City

7. Narrative Description

This building is a c.1860s, two story, three bay, brick commercial building with a storefront that has been extensively modified. The front portion of this structure appears to have been erected in the 1850s or 1860s with a back addition/reconfiguration in the 1890s. An 1866 photograph of the block shows a comparable building (Graham GR26). An 1879 photograph of the block shows the building with a more elaborate roof cornice and a second floor balcony that no longer exists. The window hoods appear to be the same. The building had a second floor balcony over the street that was subsequently removed (Graham GR162). Review of Sanborn Fire Insurance Maps show that the building was modified between 1892 and 1899 by a single story back addition that is about half as small as the original building.

The storefront is modern style storefront with two plate glass windows resting on a brick knee wall. The store entry with a typical glass retail door with a transom is offset towards the east (right) side of the store. The second story entry is adjacent and to the east (right) of the store entry. The second floor entry door is also a modern glass retail door with a transom. The storefront ceiling is wooden plywood sheeting. A new quarter circle fabric awing shelters the storefront from the elements. The second story windows have non-historic single-over-single light double-hung sashes, brick sills, and window hoods detailed with small brackets at each side supporting a low profile arch with a diamond relief set in the arch. The building cornice is a simple overhanging eave with metal flashing. The east and west elevations are party walls with the adjacent buildings. The single story rear addition appears to be brick with an infill section of concrete masonry block. The exposed rear elevation of the two story second story is brick.

8. Narrative Statement of Significance

This building does not appear individually eligible for the National Register of Historic Places under Criteria A, B, or C. However, it does appear to be a contributing building in a potential downtown historic district.

This building does not appear to be individually eligible for the National Register of Historic Places under Criteria A, B, or C. The current appearance has been altered from its original c.1860s appearance with the storefront remodeling, window replacement, and removal of the building cornice. With these alterations, it does not appear to be individually eligible under Criterion C. Additionally, it does not appear to be strongly associated with a prominent business or person. Though the Leu's restaurant and ice cream shop would grow into a significant local business, two other buildings associated with the later, more prominent history of this business remain extant in Muscatine. These buildings also retain more historic features.

However, it does appear to be a contributing building in a potential downtown historic district. It falls within two historic contexts identified for the district: "19th century Business and Industry" and "20th century Business and Industry." The overall design and proportions of the building remain intact,

Iowa Site Inventory Form Continuation Sheet

Page 4

<u>Commercial Building</u>	<u>Muscatine</u>
Name of Property	County
<u>205 West Second Street</u>	<u>Muscatine, Iowa</u>
Address	City

reflecting its historic presence at this location. The business history of this building contributes to the commercial history of the district.

This property has served many uses during its long service. The primary businesses at this location from the 1870s to the 1890's were butcher/meat markets. In 1876, Christian Hetzel started a meat market that was to be located in this block at "ns 2nd 6 E. of Pine" until 1894. The Hetzel meat market was listed on the north side of 2nd 6 east of Pine in 1876, 52 W. 2nd in 1879 and 205 W. 2nd in 1886. In the 1883-1886 City Directory, the meat market is listed as the Union Meat Market by Chris Hetzel. The 1883, 1888, and 1892 Sanborn maps show a meat market in this location. Hetzel Meats apparently discontinued operations in 1894. The building appeared to be vacant in 1895-96 as no listing was found in the city directories.

From 1897 to 1899, Fred Leu, Jr., son of Fred Leu, operated a restaurant and confectionary at 205 W. 2nd St. (City Directories). During this period (1897-1899), Fred Leu (father) was operating his ice cream and confectionary business at 215 E. 2nd St. (City Directories). The 1940 Centennial edition of the Muscatine Journal indicates that Fred Leu had been in the ice cream business in Philadelphia and Rock Island before arriving in Muscatine in 1881 to establish his own ice cream and retail business. Fred Leu started his business on West Second at 115 W. 2nd St and then moved to 215 East Second in 1890. The 1886-1887 City Directory shows Fred Leu at 115 W. 2nd. It appears that the family operated restaurants in both the 200 blocks of east and west 2nd Street between 1897 and 1899. Fred Leu retired in 1904, and his sons Harry and Rob took over. Ed Leu was also in the business for awhile. In 1922, they built a new building on Sycamore ("Leu & Son Ice Cream Manufacturers," May 31, 1940, sec. 2, p. 6).

The 1899 Sanborn indicates a millinery was at this location. This does not appear in the 1899-1901 city directories, so no other information is known. The early 1900's were a period of transition for this structure with the first floor sitting vacant in 1902-03 before Jackson Electric Company set up shop in 1904. On the 1905 Sanborn map, "electrical supplies" is depicted as the use. In 1907, Scott Britton, Photographer, had his studio at this location.

In 1908-09, Elmer E. Holmes and Clarence E. Klaffenbach set up what was to be a long run of printing operations at this location. Clarence E. Klaffenbach had started his print business in 1902 at another location. Holmes and Klaffenbach were book and job printers that occupied the 205 W. 2nd into the early 1940's with operations ceasing by 1941. The 1912, 1919, 1928 and 1946 Sanborn maps all show a publisher at this location. Starck Printing then took up printing operations in 1943 and continued operations to 1962 (City Directories).

The second floor started housing tenants by 1900. Several tenants rented occupied the second floor with special note of Mrs. Anna Buttgen who lived at this location from 1921 to 1946 and was listed as a Pennant button worker.

Iowa Site Inventory Form Continuation Sheet

Page 5

<u>Commercial Building</u> Name of Property	<u>Muscatine</u> County
<u>205 West Second Street</u> Address	<u>Muscatine, Iowa</u> City

9. Major Bibliographical References

"A Line-Up of Fine Carriages on East [West] Second Street" Photograph (Note that the photo caption mistakenly labeled the location as East Second Street), Bicentennial Edition of the *Muscatine Journal*, July 1, 1976, Sec. 3, p. 10.

City Directories, Muscatine, Various publishers, 1869-1959. Available at the Musser Public Library.

"Leu & Son Ice Cream Manufacturers," Centennial Edition, Muscatine Journal newspaper, Muscatine, Iowa, May 31, 1940, Section 2, Pg 6. Available at the Musser Public Library.

GR26 of Graham Photo Collection, Volume 1. Second & Pine Photograph, 1866. Available at the Musser Public Library.

GR162 of Graham Photo Collection, Volume 4. Second and Chestnut Photograph, 1879. Available at the Musser Public Library.

Sanborn Map Company. "Muscatine, Iowa," Sanborn fire insurance maps. Pelham, NY: Sanborn Map Company, 1883, 1888, 1892, 1899, 1907, 1912, 1919, 1928, 1946. Accessed online at: sanborn.umi.com.

Location Map

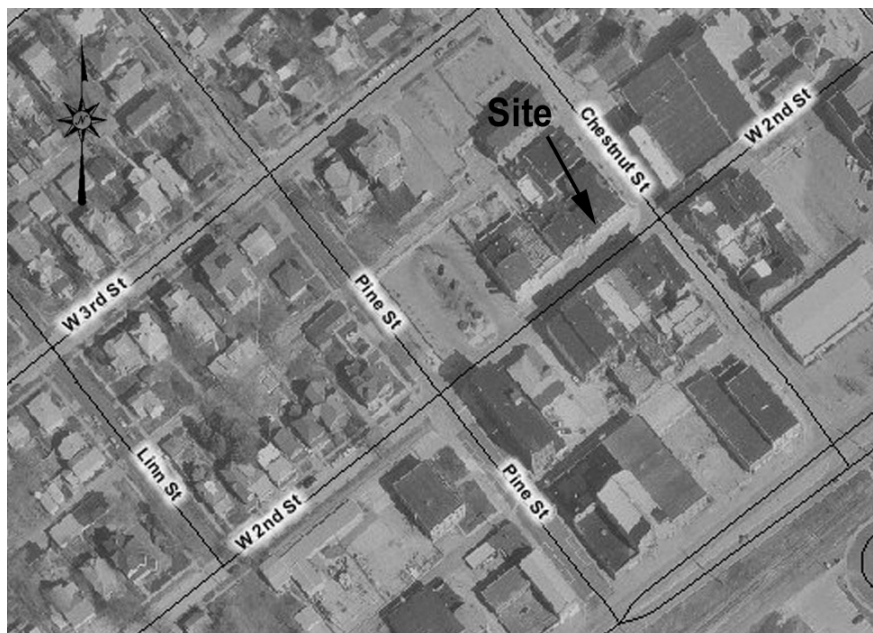

Iowa Site Inventory Form Continuation Sheet

Site Number 70-00162

Related District Number _____

Page 6

Commercial Building
Name of Property

Muscatine
County

205 West Second Street
Address

Muscatine, Iowa
City

Plan (from assessor's office)

	20
20	ADDN 1 [400]
	20
40	BLDG 1 [800]
	20
8	MTL CANOPY [160]

(front – W. 2nd St)

Photograph of building (digital image)

