

County Muscatine Address 306 W 3rd Site Number 70-00211
City Muscatine District Number 70-01005

Criteria Considerations

- A Owned by a religious institution or used for religious purposes.
- B Removed from its original location.
- C A birthplace or grave.
- D A cemetery.
- E A reconstructed building, object, or structure.
- F A commemorative property.
- G Less than 50 years of age or achieved significance within the past 50 years.

Areas of Significance (Enter categories from instructions)

02: Architecture

Significant Dates

Construction date 1860 check if circa or estimated date
Other dates _____

Significant Person

(Complete if National Register Criterion B is marked above)

Architect/Builder

Architect _____

Builder _____

Narrative Statement of Significance SEE CONTINUATION SHEETS, WHICH MUST BE COMPLETED

9. Major Bibliographical References

Bibliography See continuation sheet for citations of the books, articles, and other sources used in preparing this form

10. Geographic Data

UTM References (OPTIONAL)

Zone	Easting	Northing	Zone	Easting	Northing
1	_____	_____	2	_____	_____
3	_____	_____	4	_____	_____

See continuation sheet for additional UTM references or comments

11. Form Prepared By

name/title Jo Ann Carlson, Commission Member (R.L. McCarley, consultant)

organization Muscatine Historic Preservation Commission date 12/4/2005

street & number 215 Sycamore telephone 563-264-1550

city or town Muscatine state IA zip code 52761

ADDITIONAL DOCUMENTATION (Submit the following items with the completed form)

FOR ALL PROPERTIES

- Map:** showing the property's location in a town/city or township.
- Site plan:** showing position of buildings and structures on the site in relation to public road(s).
- Photographs:** representative black and white photos. If the photos are taken as part of a survey for which the Society is to be curator of the negatives or color slides, a photo/catalog sheet needs to be included with the negatives/slides and the following needs to be provided below on this particular inventory site:

Roll/slide sheet # _____ Frame/slot # _____ Date Taken _____
Roll/slide sheet # _____ Frame/slot # _____ Date Taken _____
Roll/slide sheet # _____ Frame/slot # _____ Date Taken _____

- See continuation sheet or attached **photo & slide catalog sheet** for list of photo roll or slide entries.
- Photos/illustrations without negatives are also in this site inventory file.

FOR CERTAIN KINDS OF PROPERTIES, INCLUDE THE FOLLOWING AS WELL

- Farmstead & District:** (List of structures and buildings, known or estimated year built, and contributing or non-contributing status)
- Barn:**
 - A sketch of the frame/truss configuration in the form of drawing a typical middle bent of the barn.
 - A photograph of the loft showing the frame configuration along one side.
 - A sketch floor plan of the interior space arrangements along with the barn's exterior dimensions in feet.

State Historic Preservation Office (SHPO) Use Only Below This Line

Concur with above survey opinion on National Register eligibility: Yes No More Research Recommended
 This is a locally designated property or part of a locally designated district.

Comments: _____

Evaluated by (name/title): _____ Date: _____

Iowa Site Inventory Form Continuation Sheet

Page 3

Henry Funck House
Name of Property

Muscatine
County

306 W 3rd
Address

Muscatine
City

7. Narrative Description

This is a two-story, three-bay, brick, Italianate house. The house sets on a brick and limestone foundation. The walls are brick, clad in brick. The roof is clad in asphalt. Large paired brackets support the wide eave around the house. The house is built on a sloped lot, with an exposed basement.

The front (north) elevation is symmetrical with three bays centered on the entry. The entry is elaborate with a carved pediment and surround. The entry has a small fanlight and sidelights incorporated into the area around the single door entry. The door is aluminum. The arch windows on each side of the entry have two-over-two-light, double-hung sashes. The top portion of the arch has a multi-light sash with a circular pattern. The arch hoods over the windows are stone, and the windows have stone sills that slightly extend out from the opening. The second story has three arch windows. The two side windows are identical to the first story. The center window is longer and has a brick arch. It also has two-over-two-light, double-hung sashes. Its top arch portion also has the multi-light sash with circular pattern seen in the other windows. There are three small rectangular two-light attic windows between the brackets along the frieze. A one-story entry porch on the early Sanborn maps was removed between 1919 and 1928.

A c.1891 historic photograph shows much of the front and west elevation of the house remains unaltered from its original condition. Two changes have occurred at the front entry and on the roof. The historic photograph shows an entry originally extended out from the house and covered the front entry. Two pairs of turned columns supported the outside of the canopy while two pilasters supported it where it connected to the house. This entry porch is seen on Sanborn maps through 1919, with no porch depicted in 1928 and 1946. The present fenestration and window design does not appear significantly different from the historic appearance. The other minor change is the loss of a roof balustrade. The historic photograph shows the balustrade centered on the main house roof. A brick chimney extends above the balustrade. Both the chimney and the balustrade are non-extant. Also gone is a wrought iron fence that extends across the front of the property. The historic photograph does show the one-story rear addition that is attached to the southwest corner of the house.

The west side features similar windows as the front with arch hoods and stone sills. Each window contains four-over-four-light, double-hung sashes. Several of the windows have a rounded multi-light top sash with a circular pattern, but in some of the windows that sash have been replaced with a solid blind. A two-story angled bay window that is located near the back of the elevation contains three windows on each story of the bay. A typical attic window is located at the top of each side of the bay window. The scrolled double brackets seen on the front continue along the cornice of the main house. The bay window is not depicted on the 1883 Sanborn map, but it is shown on the 1888 and later maps. Two similar windows, one each on the first and second stories, are centered on the west wall between the bay window and the front of the building. There is also a typical attic window located above the centered second-story window. A rear full-height section appears as an original open porch along the west side on the 1883 Sanborn map. The porch is shown as an enclosed one-story addition on the 1888 map. The

Iowa Site Inventory Form Continuation Sheet

Page 4

Henry Funck House	Muscatine
Name of Property	County
306 W 3rd	Muscatine
Address	City

addition is located between the main house and a gabled rear wing that extends to the south. The gabled wing is about one-half story shorter than the main house. There are no brackets under the addition's roof on the west elevation. The addition's basement is exposed at the rear and part of its west wall. A set of steps is located between the addition and the back of the original house and apparently leads to the original porch entry. Two-over-one-light, double-hung windows are located on the first story of the addition. There is one window on the addition's north wall, which faces the main house and one window centered on the addition's west wall. There is a basement window located slightly to the right of center on the addition's west wall. The centered window has a projecting label mold with keystone and stone sill. The addition's north window does not have the crown or the sill.

The east elevation contains the east wall of the gabled rear wing and the east wall of the main house. The same features seen on the main house's north and west elevations are repeated on the east side. These include arch hoods, scrolled double brackets, stone sills and four-over-four-light, double-hung window sashes with decorative upper sashes. Some of the decorative sashes, especially in the second-story windows have also been replaced with covers. The first- and second-story windows on this elevation rest on taller sills than the windows on the north and west walls. A typical attic window is located above each second-story window. A limestone foundation under the main building is exposed on this elevation. A portion has been removed and five openings into the basement constructed. One of the openings is a centered entry with a non-historic aluminum combination storm door. To the left of the door is a pair of one-over-one-light, double-hung windows. The windows have stone sills. A slightly larger pair of windows is located to the right of the centered door. These also contain one-over-one-light, double-hung sashes and stone sills. There is also a small one-over-one-light, double-hung basement window located near the back of the main house. This window appears to have a wide lintel and sill that are flush with the plane of the east wall. The remaining openings on the east side are located on the two-story gabled rear wing. A window and an entry are located on the first story and two windows are located directly above them on the second story. Each window contains two-over-two-light, double-hung sashes with stone sills. The two second-story windows also contain label molds, while the two first-story openings have more basic straight-line crowns. Because of the exposed basement wall on this elevation, the entry, which is located on the wing's east wall where it connects to the main house, is accessed from a set of wood steps. The steps lead to a common landing that is shared by the wing's east wall entry and another entry located on the main house's exposed south wall. The entry on the wing's east wall contains an aluminum combination storm door. There are also two openings in the basement's east wall. An entry is located directly below the first-story entry. It contains an aluminum combination storm door. A small plate covers the second basement opening, which is located to the left of the basement entry and under the other first- and second-story windows.

Three different walls of the building are exposed on the rear (south) elevation. The south wall of the one-story addition includes both first-story and basement windows. Both windows are centered on the wall and contain two-over-one-light, double-hung sashes. The first-story window is crowned with a label mold while the basement window contains the straight-line mold. The rear wall of the gabled, two-story rear wing contains six openings. There are two openings on each story, each aligned with the other. The first- and second-story openings are windows, with typical label mold crowns and stone sills. The right

Iowa Site Inventory Form Continuation Sheet

Page 5

Henry Funck House
Name of Property

Muscatine
County

306 W 3rd
Address

Muscatine
City

windows on each of these floors contain two-over-two-light, double-hung sashes. The left windows contain two-over-one-light, double-hung sashes. The basement openings include a window on the left and an entry on the right. The basement window has the same label mold as the other rear elevation windows on this wall, but contains one-over-one-light, double-hung sashes. The entry opening is crowned with the same molding. However, it contains a flush-mounted aluminum combination storm door with a solid interior door. A stone band extends across the wall and around the corners between the first story and the basement. A series of single brackets also extend along the cornice of the gable. A portion of the main house's original south wall also remains exposed on the right side of this elevation and above the one-story addition on the left side. A second-story window on the west side of the main house wall is visible above the addition. It shows the top portion of what appears to be a similar window as the front and side windows of the main house. It has a segmental arch, but the upper decorative sash has been covered over. The gabled rear wing does not extend completely to the east edge of the main house. This exposed wall contains two openings. Originally, both were likely windows, but the first-story opening has now been converted into an entry. Both openings are aligned with each other and set just to the right of the junction of the rear wing with the main house. Each has a segmental arch crown. The second-story window contains two-over-one-light, double-hung sashes and a stone sill. The converted door opening contains an aluminum storm door. It is accessed from the common landing that also provides access to the nearby entry located in the east wall of the rear wing. The typical double scrolled brackets, which extend along the cornice on the other elevations of the main house, are also located on the rear elevation.

The Sanborn maps in 1888 show the house as having the additions on the back and the porches on the side. The rest of the Sanborn maps, the house stays the same.

8. Narrative Statement of Significance

The Henry Funck House appears to be individually eligible for the National Register of Historic Places under Criterion C. It also appears to be a contributing building in a potential "West Hill" neighborhood historic district.

Henry Funck, a businessman and banker, built this house as a family residence around 1860. Funck arrived in Muscatine in 1839 and became involved in the grocery and bakery business, eventually entering the banking business. Although he also served as mayor for two years and alderman for four years, he does not appear to have made a substantial impact on the history of Muscatine. No significant event is known to have occurred on the property. The house however is an excellent example of an Italianate house. It retains much of its integrity, including ornamental window hoods, stone sills, and original multi-light windows. Its large presences, ornamented entry, arch windows with full arch hoods, large brackets, and wide eaves make it stand out from other Italianate houses in Muscatine. Thus, the Henry Funck House appears to be individually eligible for the National Register of Historic Places under Criterion C.

Iowa Site Inventory Form Continuation Sheet

Page 6

Henry Funck House	Muscatine
Name of Property	County
306 W 3rd	Muscatine
Address	City

The Henry Funck House also appears to be a contributing building in a potential “West Hill” neighborhood historic district. Funck was an original settler of Muscatine and through the years became an important resident in the city. He began and operated several businesses in Muscatine and also served as an elected official. When he chose West Hill as the location for his large and imposing new home, it likely made a significant impact on local residents and helped establish the neighborhood’s reputation as an upper class neighborhood. His decision helped the neighborhood maintain its 19th century growth and development and encouraged others to consider the neighborhood. In addition, the house retains a significant amount of integrity. Much of the ornamentation remains and windows and doors still retain many of the original sashes and other features. This house contributes significantly to the history and architecture of this potential historic district.

Myron Ward bought Lots 7 and 8 of Block 36 in 1850, according to the abstract (Book J, Page 250). He sold both lots to Henry Funck on September 15, 1859 (Book U, Page 4). An 1889 biography of Henry Funck notes that by 1861 he had “built his elegant residence at the southwest corner of Pine and Third streets.” This suggests a c.1860 construction date for this house. The biography continues to note that “enterprising and sagacious in his undertakings, he was eminently successful, and the elegant residence, now a home of his widow and son, Adam, situated on West Third street, is a monument to his enterprise and good taste.” Funck emigrated from Germany with his wife Anna C. whose maiden name was also Funck, in 1837, the same year they were married. After living in St. Louis and Burlington for about two years, they arrived in Muscatine in 1839, making them one of the earliest settlers of the new community. Funck became involved with the grocery and bakery business and continued with that trade until 1852. However, he is not listed among any of the businesses, grocery or otherwise, recorded in Newhall’s 1845 Bloomington Directory. After leaving the grocery business, Funck built a distillery and operated it for three years. He then sold out and began operating a boat stores and wharf enterprise, which he also sold after three years. Henry Funck is not listed in the 1856 directory, although a “George Funk”, grocer, is listed. “George Funk” is likely a misspelling of Henry’s son George A. The same misspelling occurs in the 1859 directory, although that listing is recorded as “George A. Funk, wholesale and retail groceries, liquors and provisions. It records his address as “ns of Burlington Road w of Green.” Henry Funck is listed in the 1859 directory just below his son. No occupation is listed for him, but his residence is identified as “n e c Chestnut and 1st.” Henry Funck could not be identified in the 1860 census record. Funck and his wife had eight children. George Adam, who married Julia Lacy; Ada Cornelia, who married Fred Daut; Amelia Laura, wife of Henry Prengler (she died on March 12, 1875); Kate, married S.E. Jacobson; Lizzie, 17, died July 6, 1876; Clara, married Newton W. Hine (she died March 26, 1887); Henry S, who died December 12, 1846; and Henrietta, who died October 13, 1850.

Around 1860 when Funck built this house, he had entered the banking business, eventually working for Cook, Musser and Company Two Henry Funcks are listed in the 1866 directory, including one who is identified as the “ex-mayor,” with his residence at “Third sw cor Pine.” In 1869, he is listed between Pine and Linn on 3rd. No occupation is listed in this directory. Henry Funck, 53, is also recorded in the 1870 census. He is recorded in possession of \$23,000 in real estate and \$10,000 in personal wealth. Also listed in the Funck household are Catherine, 52; G.A., 31, a tobacconist; Laura, 18; Kate, 16; Lizzie, 14; and Clara, 10. In 1874, Henry is listed at 3rd west of Pine. In 1876, Henry is listed as living at 3rd & Pine

Iowa Site Inventory Form Continuation Sheet

Page 7

Henry Funck House
Name of Property

Muscatine
County

306 W 3rd
Address

Muscatine
City

and in 1877 he is listed at 3rd SW corner of Pine. He is listed as retired in the city directories. Also during this period, he became a partner with his son-in-law Fred Daut in Daut's tobacco wholesale business. He retired from that on January 1, 1879. During his business career, he also found time to serve four years as a city alderman and two years as the mayor. He died on June 6, 1886.

After Henry Funck died, the property remained in the family. The 1889-92 city directory identified G.A. Funck, retired, as the resident. The directory also listed his mother, Mrs. Henry Fauck, widow, as a resident of 306 W. Third. G. Adam Funck, secretary and treasurer of the Muscatine Implement Company, continued to be listed as the resident in the 1895-95 city directory. In the 1900 city directory, G.A. and his wife Julia were identified as the residents. He was the president of the Muscatine News Company at that time. The 1900 census confirmed them at 306 W. Third. Others at that address included Julia, 42; daughter Cornelia, 18; mother Anna C. Funck, 82; and Anna Edman, a servant, 25. Mrs. Henry Funck died July 25, 1901. According to her obituary in the Muscatine Journal, Mrs. Funck was 84 years and 21 days old. She was born in Altheim, Hesse-Darmstadt, Germany on July 4, 1818. They had eight children, three of whom survived her: George Adam, Ada Cornelia, wife of Frederick Daut, who recently retired from the wholesale grocery business, and Mrs. Kate Funck, of Chicago. The children who had passed were Lizzie, who died 1876, Mrs. Clara Hine, who died 1887, Henry S., died 1846, and Henrietta, died in 1850.

George A. Funck continued to be listed as the resident from 1901 through the 1927 city directories. G.A. Funck is listed in the 1904 city directory with his wife Julia. He is listed as retired. The 1910 census lists George as Adam G. and Julia Funck at 306 West 3rd Street and he is listed as retired. The listings remain the same through 1927, with George and Julia both listed here, and George was retired.

From the 1929 through the 1934 city directory, Mrs. Julia A. Funck, widow of Adam, was the listed resident. It is assumed Julia died sometime between 1934 and 1937, because Mrs. Cornelia Funck Woodcock, widow of Jas, is listed as the resident.

The property is listed as vacant in the 1938-39 through the 1943 city directories

There appears to have been an estate settlement of the property prior to 1938 that transferred the land from Cornelia Funck Woodcock to James Henry Lincoln Stafford. Stafford then transferred the land to Waldo E. Stafford on January 18, 1938 (Book 87, Page 122). A series of transfers from Stafford's heirs occurred through the remainder of the 1930s and into the 1940s that transferred the property to Herman Gremmel. Louise Gremmel then transferred the property to Edward Gremmel on February 3, 1944 (Book 110, Page 105).

Otha H. Johnson acquired the property from Gremmel on May 27, 1946 (Book 118, Page 509). Johnson apparently did not immediately live in the house, but rented it. The 1946 city directory listed Chas Schrimp, occupation not listed, as the only resident. The 1949 city directory did list Otha Johnson as one of the residents of what was now identified as a seven-unit apartment house. Others listed in the building were Gladys Krantz, Chas Starkweather, John Barton, Stanley Main and Mrs. Bertha Lucas. No

Iowa Site Inventory Form Continuation Sheet

Site Number 70-00211

Related District Number 70-01005

Page 8

Henry Funck House
Name of Property

Muscatine
County

306 W 3rd
Address

Muscatine
City

occupations were listed for any of the tenants. There were actually nine apartments identified in the 1952 city directory. It is unknown if the number of apartments had been increased by 1952 or the 1949 directory had not listed all of the units. Johnson continued to be listed as one of the residents, along with Retha Keller, Chas. Dickinson, Francis Bodman, Glenn Baker, Vivian Allison, Edwin Peters and one vacant unit.

Clayton Welsch purchased the property on March 10, 1952 from Johnson (Book 141, Page 230). Welsch transferred the property to Lowell and Norma Titus on September 27, 1958 (Book 186, Page 180). Lowell Titus remodeled the residence for \$2500 on November 7, 1958 (Muscatine Journal December 30, 1958, Section 4, Page 17). In 1961 it was named the Titus Apartments.

9. Major Bibliographical References

"Building Permits," *Muscatine Journal*, December 30, 1958, Section 4, Page 17.

Census Records, United States Census Bureau, 1870, 1900, 1910, 1920.

City Directories, Muscatine. Various publishers, 1856-1959. Available as the Musser Public Library.

Home of G.A. Funck, Historic Photograph ca. 1913, *Muscatine, The Pearl City*, accessed on-line at <http://www.rootsweb.com/~iamuscat/semicent/resfunck.gif>

Portrait and Biographical Album of Muscatine County, Iowa, Vol II, Biographical. Chicago: Acme Publishing, 1889, Page 502.

Sanborn Map Company. "Muscatine, Iowa," Sanborn fire insurance maps. Pelham, NY:
Sanborn Map Company, 1883, 1888, 1892, 1899, 1907, 1912, 1919, 1928. Accessed online at:
Sanborn.umi.com.

Iowa Department of Cultural Affairs
 State Historical Society of Iowa
Iowa Site Inventory Form
Continuation Sheet

Site Number 70-00211
 Related District Number 70-01005

Page 9

Henry Funck House
 Name of Property

Muscatine
 County

306 W 3rd
 Address

Muscatine
 City

Location Map



Plans of buildings on site (from assessor's office)

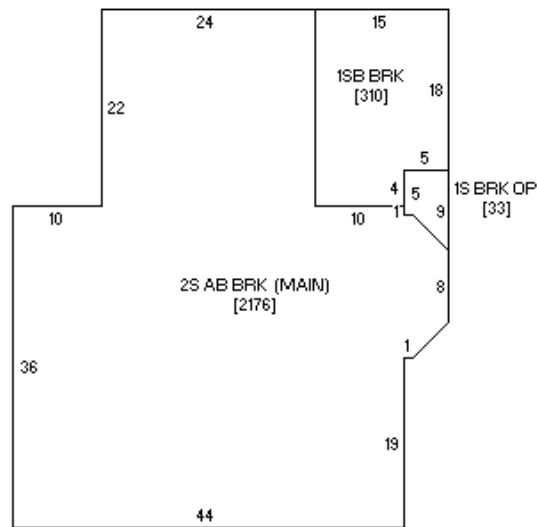

(front – W. 3rd Street)

Iowa Site Inventory Form Continuation Sheet

Site Number 70-00211

Related District Number 70-01005

Page 10

Henry Funck House
Name of Property

Muscatine
County

306 W 3rd
Address

Muscatine
City

Photograph of building (digital image)

