

Site Inventory Form
State Historical Society of Iowa
 (December 1, 1999)

State Inventory No. 70-01098 **New** **Supplemental**
 Part of a district with known boundaries (enter inventory no.) 70-01005
 Relationship: Contributing Noncontributing
 Contributes to a potential district with yet unknown boundaries
 National Register Status: (any that apply) Listed De-listed NHL DOE
 Review & Compliance No. _____
 Non-Extant (enter year) _____

1. Name of Property

historic name Glen and Carolyn Bloom House
 other names/site number Field Site #: WH-114

2. Location

street & number 301 Ash Street
 city or town Muscatine vicinity, county Muscatine
 Legal Description: (If Rural) Township Name _____ Township No. _____ Range No. _____ Section _____ Quarter of Quarter _____
 (If Urban) Subdivision Original Town Block(s) 48 Lot(s) 1

3. State/Federal Agency Certification [Skip this Section]

4. National Park Service Certification [Skip this Section]

5. Classification

Category of Property (Check only one box)	Number of Resources within Property		
	If Non-Eligible Property	If Eligible Property, enter number of:	
	Enter number of:	Contributing	Noncontributing
<input checked="" type="checkbox"/> building(s)	_____ buildings	<u>1</u>	_____ buildings
<input type="checkbox"/> district	_____ sites	_____	_____ sites
<input type="checkbox"/> site	_____ structures	_____	_____ structures
<input type="checkbox"/> structure	_____ objects	_____	_____ objects
<input type="checkbox"/> object	_____ Total	<u>1</u>	_____ Total

Name of related project report or multiple property study (Enter "N/A" if the property is not part of a multiple property examination).
 Title _____ Historical Architectural Data Base Number _____

A Historical and Architectural Survey of the "West Hill" neighborhood, Muscatine, Iowa 70-016

6. Function or Use

Historic Functions (Enter categories from instructions)	Current Functions (Enter categories from instructions)
<u>01A01: Domestic / Single residence</u>	<u>01A01: Domestic / Single residence</u>
_____	_____
_____	_____

7. Description

Architectural Classification (Enter categories from instructions)	Materials (Enter categories from instructions)
<u>09A07: House / Ranch</u>	foundation <u>10A: Concrete block</u>
_____	walls <u>05F: Steel</u>
_____	roof <u>08A: Asphalt Shingle</u>
_____	other _____

Narrative Description (SEE CONTINUATION SHEETS, WHICH MUST BE COMPLETED)

8. Statement of Significance

Applicable National Register Criteria (Mark "x" representing your opinion of eligibility after applying relevant National Register criteria)

<input checked="" type="checkbox"/> Yes <input type="checkbox"/> No <input type="checkbox"/> More Research Recommended	A	Property is associated with significant events.
<input type="checkbox"/> Yes <input checked="" type="checkbox"/> No <input type="checkbox"/> More Research Recommended	B	Property is associated with the lives of significant persons.
<input type="checkbox"/> Yes <input checked="" type="checkbox"/> No <input type="checkbox"/> More Research Recommended	C	Property has distinctive architectural characteristics.
<input type="checkbox"/> Yes <input type="checkbox"/> No <input type="checkbox"/> More Research Recommended	D	Property yields significant information in archaeology or history.

County Muscatine
City Muscatine

Address 301 Ash Street

Site Number 70-01098
District Number 70-01005

Criteria Considerations

- A Owned by a religious institution or used for religious purposes.
- B Removed from its original location.
- C A birthplace or grave.
- D A cemetery
- E A reconstructed building, object, or structure.
- F A commemorative property.
- G Less than 50 years of age or achieved significance within the past 50 years.

Areas of Significance (Enter categories from instructions)

31: Other – neighborhood development

Significant Dates

Construction date 1960 check if circa or estimated date
Other dates _____

Significant Person

(Complete if National Register Criterion B is marked above)

Architect/Builder

Architect _____

Builder _____

Narrative Statement of Significance (SEE CONTINUATION SHEETS, WHICH MUST BE COMPLETED)

9. Major Bibliographical References

Bibliography See continuation sheet for citations of the books, articles, and other sources used in preparing this form

10. Geographic Data

UTM References (OPTIONAL)

Zone	Easting	Northing	Zone	Easting	Northing
1	_____	_____	2	_____	_____
3	_____	_____	4	_____	_____

See continuation sheet for additional UTM references or comments

11. Form Prepared By

name/title Barb Sabbath / Rebecca Lawin McCarley, consultant

organization Muscatine Historic Preservation Commission date February 15, 2006

street & number 215 Sycamore telephone 563-264-1550

city or town Muscatine state IA zip code 52761

ADDITIONAL DOCUMENTATION (Submit the following items with the completed form)

FOR ALL PROPERTIES

- Map:** showing the property's location in a town/city or township.
- Site plan:** showing position of buildings and structures on the site in relation to public road(s).
- Photographs:** representative black and white photos. If the photos are taken as part of a survey for which the Society is to be curator of the negatives or color slides, a photo/catalog sheet needs to be included with the negatives/slides and the following needs to be provided below on this particular inventory site:

Roll/slide sheet # _____	Frame/slot # _____	Date Taken _____
Roll/slide sheet # _____	Frame/slot # _____	Date Taken _____
Roll/slide sheet # _____	Frame/slot # _____	Date Taken _____

- See continuation sheet or attached **photo & slide catalog sheet** for list of photo roll or slide entries.
- Photos/illustrations without negatives are also in this site inventory file.

FOR CERTAIN KINDS OF PROPERTIES, INCLUDE THE FOLLOWING AS WELL

- Farmstead & District:** (List of structures and buildings, known or estimated year built, and contributing or non-contributing status)
- Barn:**
 - A sketch of the frame/truss configuration in the form of drawing a typical middle bent of the barn.
 - A photograph of the loft showing the frame configuration along one side.
 - A sketch floor plan of the interior space arrangements along with the barn's exterior dimensions in feet.

State Historic Preservation Office (SHPO) Use Only Below This Line

Concur with above survey opinion on National Register eligibility: Yes No More Research Recommended
 This is a locally designated property or part of a locally designated district.

Comments: _____

Evaluated by (name/title): _____ Date: _____

Iowa Site Inventory Form Continuation Sheet

Page 3

Glen Bloom House
Name of Property

Muscatine
County

301 Ash Street
Address

Muscatine
City

7. Narrative Description

This is a one-story, four-bay, ranch house built in 1960. The left (north) bay was added soon after the original construction, around 1962. The house sits on a concrete block foundation. The walls are frame, clad in wide steel siding. The hip roof is clad in asphalt shingles. The house sits on a hill, and curved concrete steps lead from the end of the driveway up to the entry.

The house sits on the corner of 3rd Street and Ash Street, facing Ash to the west. The entry area is recessed on the center of the original house. This area is about 14 by 4 feet, and brick veneer clads the walls in this area. The entry is located on the left portion of the recessed wall. The wood door with three small descending windows appear original. A large picture window is located to the right. In photograph showing the completed house, published on December 30, 1960, it appears that this window originally had divided lights. The section to the right (south) of the entry area has a set of four tall 18-light casement windows that extend around the southwest corner to include two additional 18-light windows on the south elevation. The section to the left of the entry area has three tall 12 light casement windows centered on this section. A basement garage is located below these windows. The one-car garage has a non-historic garage door, and a single-door pedestrian entry to the right. Stone retaining walls line either side of the driveways that extends to Ash. These retaining walls and the curved concrete steps leading to the entry of the house appear in the December 30, 1960 photograph of the house. The section to the left (north) of this section does not appear in this photograph, and it was added around 1962. This section sits on a concrete block foundation. Four single-light sliding windows are centered on this section.

The south elevation, facing 3rd Street, includes the two 18-light windows that are part of the set that wraps around the southwest corner. Two smaller nine-light casement windows are found near the east portion of this elevation.

The north elevation is the side elevation of the side addition, and the north side of the original house. The addition covers about the front half of the elevation. A large brick chimney is located near the front of the elevation on the side of the addition. A single-door entry is to the left of the chimney. The side of the original house has a nine-light casement window.

Five window openings stretch across the rear (east elevation) of the house. All the windows have nine-light casement windows, and the second opening from the left (south) contains a pair of windows.

8. Narrative Statement of Significance

The Glen Bloom House does not appear to be individually eligible for the National Register of Historic Places under Criteria A, B, or C. However, it may be a contributing building in a potential "West Hill" neighborhood historic district.

Iowa Site Inventory Form Continuation Sheet

Page 4

Glen Bloom House
Name of Property

Muscatine
County

301 Ash Street
Address

Muscatine
City

Glen Bloom House is one of the later houses constructed in the West Hill neighborhood, built in 1960. This ranch style house reflects the typical style of the houses built in the 1950s in the neighborhood, as well as throughout the remainder of Muscatine. Unlike many of these houses, this one has a side addition that has altered the original plan. Therefore, it does not appear to be a particular outstanding example of this style. Additionally, the Glen Bloom House does not appear associated with any particular events. Glen Bloom was an advertising manager for Kent Feeds, and it does not appear that he made any significant contributions to the community. Thus, the Glen Bloom House does not appear to be individually eligible for the National Register of Historic Places under Criteria A, B, or C.

However, the Glen Bloom House may be a contributing building in a potential "West Hill" neighborhood historic district. Though 1960 is chosen as the survey cut-off date, the end of the period of significance for a potential West Hill nomination may be 1956 or 1957, fifty years ago. If this is chosen as the end date, then this house would not be contributing in the district. However, if the period of significance is extended through 1960, then this house would be contributing.

A building permit was issued to Glen and Carolyn Bloom on July 6, 1960 for \$12,000 to construct a house at "815 W. 3rd Street," which is this house. The house ended up facing Ash Street, with an address on Ash. A photograph appeared in the *Journal* on December 30, 1960 noting that the house was built to take advantage of the river view. It shows a similar house to the current building, with the exception of the north addition. The caption also notes that a 33-foot combination living room and dining room extends across the front of the house. The kitchen and eating area had wood paneling. The house also included three bedrooms and two bathrooms. The 1961 city directory continues to list Glen A. Bloom living at 314 Broadway, which he sold in November 1960 to moved to this new house. The 1963 city directory lists Glen A. and Carolyn Bloom living at 301 Ash Street. Glen was the director of advertising at Kent Feeds. Glen lived here until his death on May 30, 2002. His obituary noted that he was born on September 24, 1922 in Muscatine, and he excelled in high school sports. He served in World War II in the Azores, and he attended the University of Iowa after his service. He married Carolyn Ruthenberg on March 13, 1945 in Muscatine. He initially taught school and served as principal, before beginning to work for Kent Feeds in 1954. He worked in advertising for Kent Feeds, and then Grain Processing Corporation, for 28 years until he retired in 1982 as vice president of personnel. He was active in Wesley United Methodist Church, 33 Club, and Elks Lodge No. 304. He also served on the Golf Course Committee that built the Muscatine Municipal Golf Course, the Civil Service Commission, the Levee Commission, the YMCA board, and the United Way board ("Glen Bloom," *Journal*, May 31, 2002, 5A).

Carolyn L. Bloom continues to reside in this house in early 2006.

9. Major Bibliographical References

"Bloom House has River View," *Muscatine Journal*, December 30, 1960, Section 2, page 15.

Iowa Department of Cultural Affairs
State Historical Society of Iowa
**Iowa Site Inventory Form
Continuation Sheet**

Site Number 70-01098
Related District Number 70-01005

Page 5

Glen Bloom House	Muscatine
Name of Property	County
301 Ash Street	Muscatine
Address	City

“Building Permits,” *Muscatine Journal*, December 30, 1960, Section 3, page 13.

“Glen Bloom,” *Journal*, May 31, 2002, 5A

City Directories, Muscatine. Various publishers, 1959-19--. Available as the Musser Public Library.

Deed/Abstract Records, Recorder’s Office, Muscatine County Courthouse, Muscatine, Iowa.

Location Map

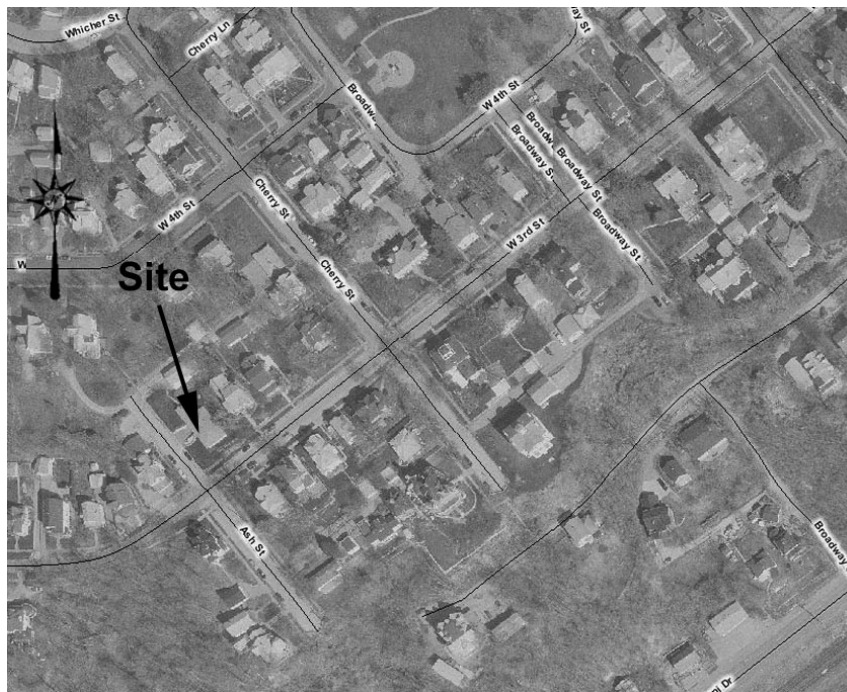

Iowa Site Inventory Form Continuation Sheet

Page 6

Glen Bloom House
Name of Property

Muscatine
County

301 Ash Street
Address

Muscatine
City

Plans of buildings on site (from assessor's office)

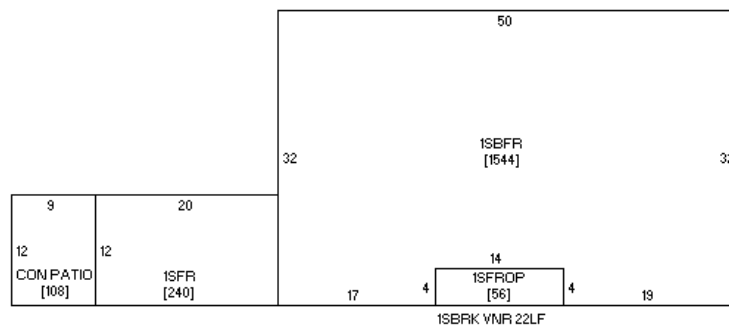

(front – Ash Street)

Photograph of building (digital image)

