

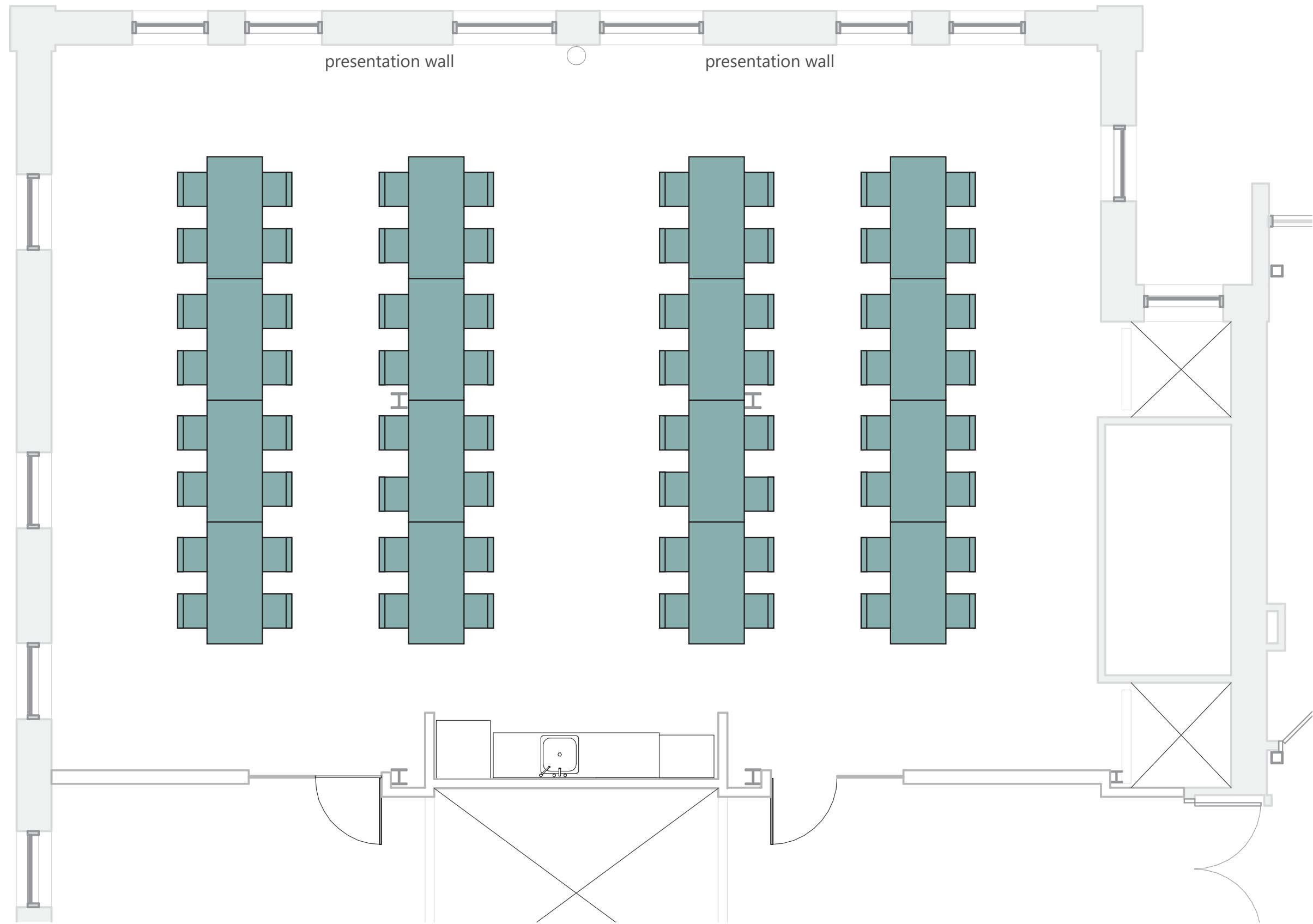

Program Room 301 - Plan Layout A
Tables & Chairs / Face-to-Face Seating / Horizontal Orientation: **72 Seats**



Program Room 301 - Plan Layout B

Tables & Chairs / Face-to-Face Seating / Vertical Orientation: **64 Seats**

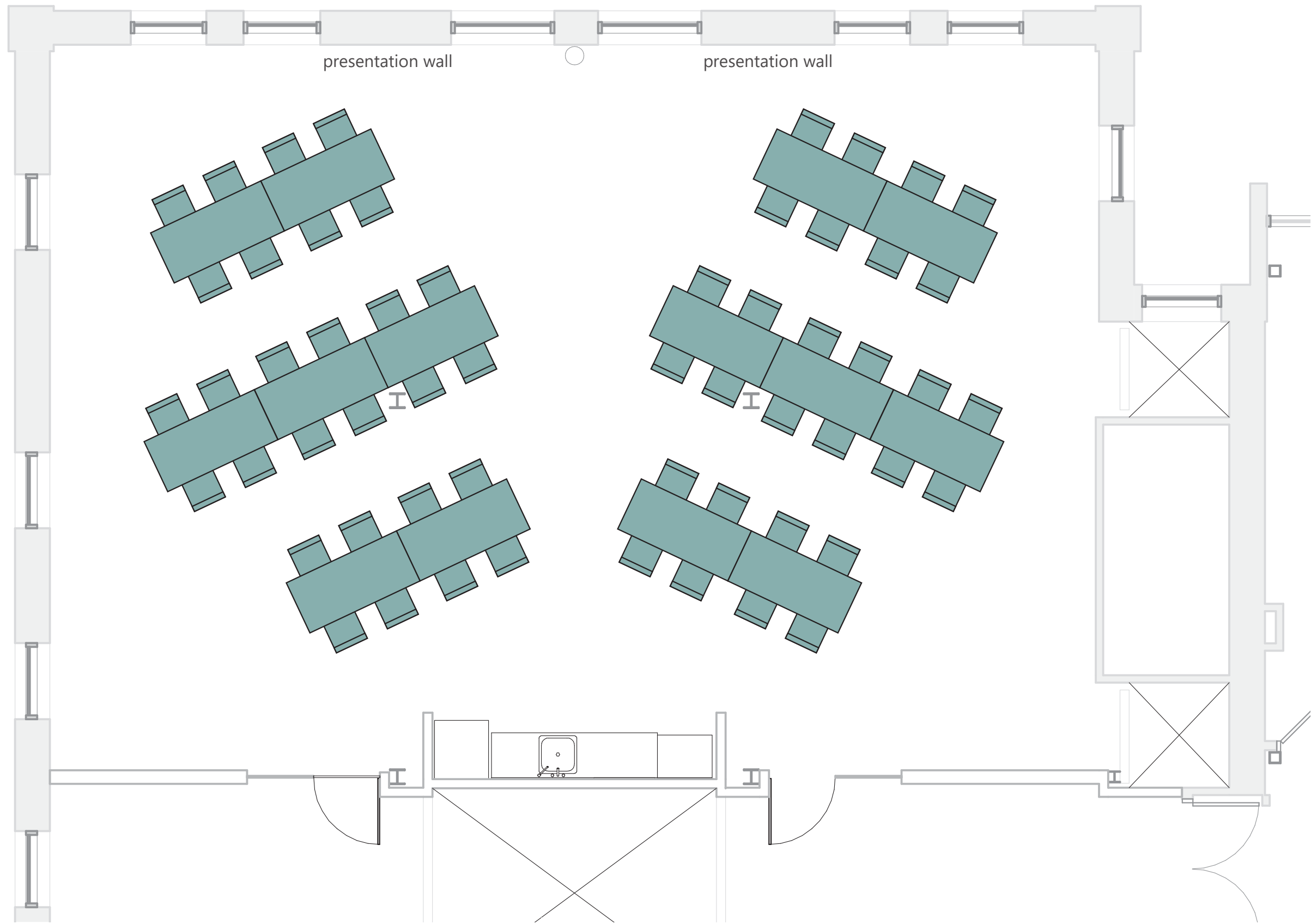

Program Room 301 - Plan Layout C
Tables & Chairs / Face-to-Face Seating / Angled Orientation: **56 Seats**

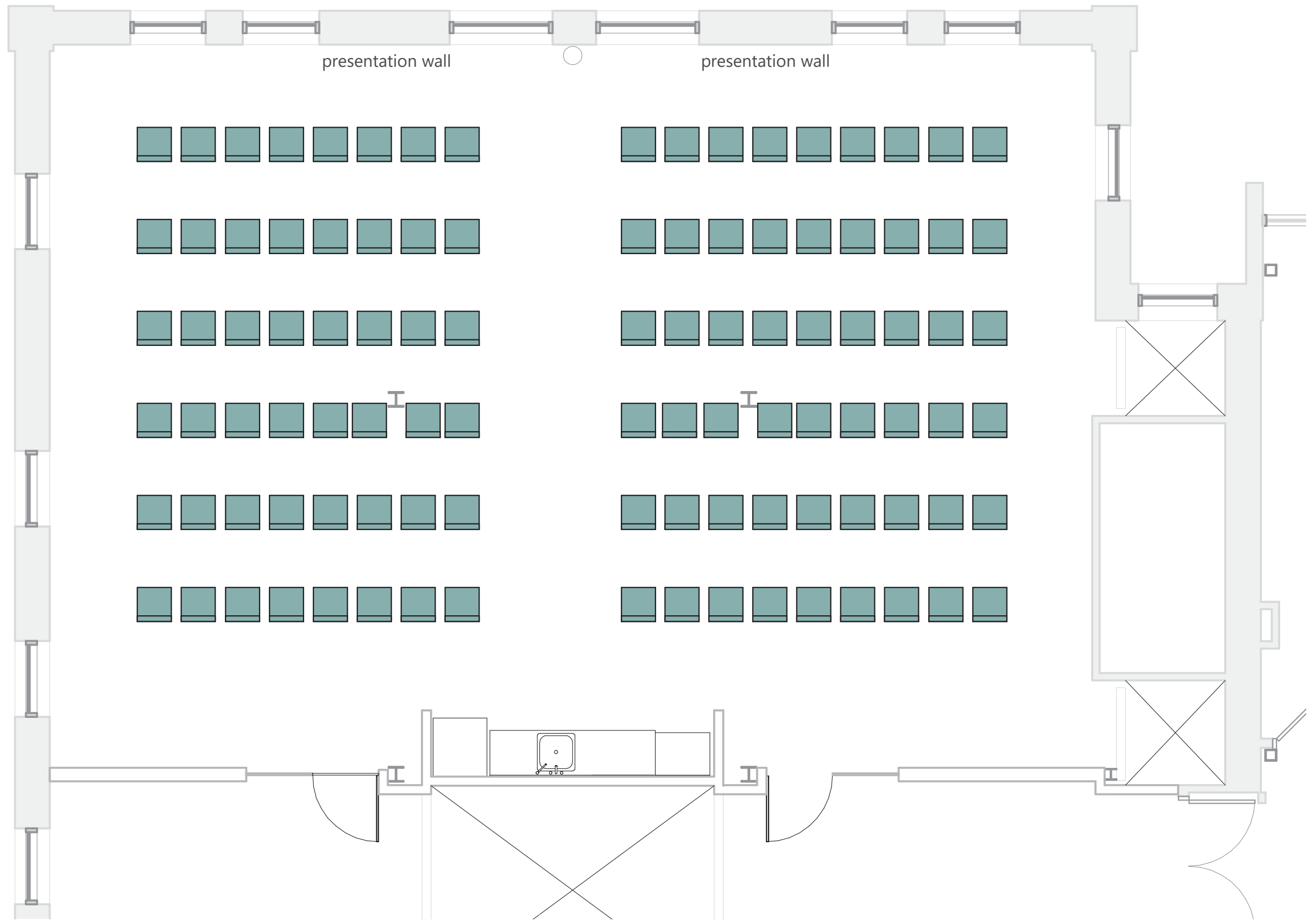

Program Room 301 - Plan Layout D
Chairs Only / Auditorium Style Seating: **102 Seats**